

PT25-C

G3 2006.01.01->

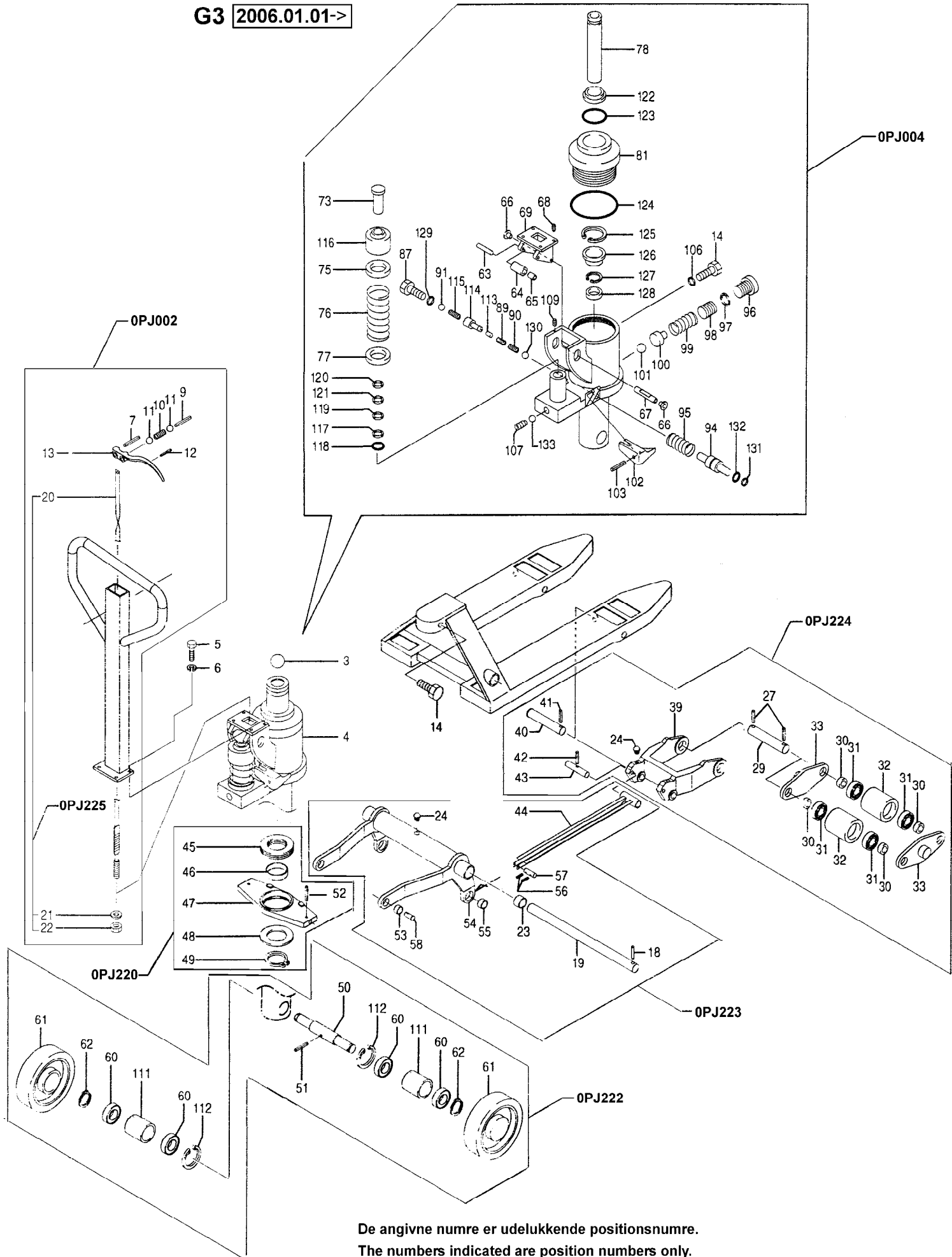

De angivne numre er udelukkende positionsnumre.
 The numbers indicated are position numbers only.
 Die angegebenen Nummer sind Positoinnummer ausschließlic.
 Les numéros indiqués position uniquement.

PT25-C G3

Pos.	No.	DANSK.	DEUTSCH.	ENGLISH.	FRANÇAIS.	
**	3	0PJ200	Kugle	Kugel	Ball	Bille
**	5	0PJ005	Skrue	Schraube	Screw	Vis
**	6	0PJ006	Skive	Scheibe	Washer	Disque
	7	0PJ002	Rørstift	Rohrstift	Tube sprig	Goujon
	9	0PJ002	Rørstift	Rohrstift	Tube sprig	Goujon
	10	0PJ002	Fjeder	Feder	Spring	Ressort
	11	0PJ002	Kugle	Kugel	Ball	Bille
	12	0PJ002	Rørstift	Rohrstift	Tube sprig	Goujon
	13	0PJ002	Betjeningsgreb	Handgriff	Handle	Manche
**	14	0PJ200	Skrue	Schraube	Screw	Vis
	18	0PJ223	Rørstift	Rohrstift	Tube sprig	Goujon
	19	0PJ223	Aksel	Achse	Shaft	Axe
	20	0PJ002/ 0PJ225	Trækstang	Zugstange	Pull Rod	Barre de traction
	21	0PJ002/ 0PJ225	Skive	Scheibe	Washer	Disque
	22	0PJ002/ 0PJ225	Møtrik	Mutter	Nut	Ecrou
	23	0PJ223	Bøsning	Buchse	Axle sleeve	Manchon
	24	0PJ223/ 0PJ224	Smørenippel	Ölnippel	Oil eye	Raccord d'huile
	27	0PJ224	Rørstift	Rohrstift	Tube sprig	Goujon
	29	0PJ224	Aksel	Achse	Shaft	Axe
	30	0PJ224	Skive	Scheibe	Washer	Disque
	31	0PJ224	Kugleleje	Kugellager	Ball bearing	Palier à billes
	32	0PJ224	Hjul	Rad	Wheel	Roue
	33	0PJ224	Hjul plade	Blech f. Rad	Plate f. wheel	Support p. roue
	39	0PJ224	Ramme f. hjul	Rollenausleger	Frame of wheel	Support p. roue
	40	0PJ224	Aksel	Achse	Shaft	Axe
	41	0PJ224	Rørstift	Rohrstift	Tube sprig	Goujon
	42	0PJ224	Rørstift	Rohrstift	Tube sprig	Goujon
	43	0PJ224	Aksel	Achse	Shaft	Axe
	44	0PJ223	Parallelogramstang	Parallelogramm	Parallelogram	Parallelogramme
	45	0PJ220	Kugleleje	Kugellager	Ball bearing	Palier à billes
	46	0PJ220	Bøsning	Buchse	Axle sleeve	Manchon
	47	0PJ220	Løfteåg	Hubstange	Lifting lever	Levier de levage
	48	0PJ220	Skive	Scheibe	Washer	Disque
	49	0PJ220	Låsering	Seegerring	Lock ring	Circlips
**	50	0PJ222	Aksel	Achse	Shaft	Axe
**	51	0PJ222	Rørstift	Rohrstift	Tube sprig	Goujon
	52	0PJ220	Rørstift	Rohrstift	Tube sprig	Goujon
	53	0PJ223	Bøsning	Buchse	Bushing	Manchon
	54	0PJ223	Arm	Arm	Arm	Bras
	55	0PJ223	Bøsning	Buchse	Bushing	Manchon
	56	0PJ223	Rørstift	Rohrstift	Tube sprig	Goujon
	57	0PJ223	Aksel	Achse	Shaft	Axe
	58	0PJ223	Aksel	Achse	Shaft	Axe
	60	0PJ222	Leje	Lager	Bearing	Palier
	61	0PJ222	Hjul	Rad	Wheel	Roue
	62	0PJ222	Låsering	Seegerring	Lock ring	Circlips
	63	0PJ004/ 0PJ200	Aksel	Achse	Shaft	Axe
	64	0PJ004/ 0PJ200	Bøsning	Buchse	Bushing	Manchon
	65	0PJ004/ 0PJ200	Bøsning	Buchse	Bushing	Manchon
	66	0PJ004/ 0PJ200	Bøsning	Buchse	Bushing	Manchon
	67	0PJ004/ 0PJ200	Aksel	Achse	Shaft	Axe
	68	0PJ004/ 0PJ200	Skrue	Schraube	Screw	Vis
	69	0PJ004	Flange	Flansch	Collar	Collet
	73	0PJ004/ 0PJ200	Pumpestempel	Pumpenkolben	Pump piston	Piston de pompe
	75	0PJ004/ 0PJ200	Fjeder kop	Feder teil	Spring part	Support de Ressort
	76	0PJ004/ 0PJ200	Fjeder	Feder	Spring	Ressort
	77	0PJ004/ 0PJ200	Fjeder kop	Feder teil	Spring part	Support de Ressort
	78	0PJ004	Stempel	Kolben	Piston	Piston
	81	0PJ004	Pakdåse	Stopfbuchse	Stuffing box	Ecrou de piston
	87	0PJ004/ 0PJ200	Ventilprop	Ventilschraube	Valve plug	Bouchon de valve
	89	0PJ004/ 0PJ200	Fjeder	Feder	Spring	Raccord
	90	0PJ004/ 0PJ200	Ventilkegle	Ventileinsatz	Valve insertion	Douille
	91	0PJ004/ 0PJ200	Kugle	Kugel	Ball	Bille
	94	0PJ004/ 0PJ200	Ventil nål	Ventil nadle	Valve needle	Aiguille de valve
	95	0PJ004/ 0PJ200	Fjeder	Feder	Spring	Raccord
	96	0PJ004/ 0PJ200	Prop	Verschraubung	Plug	Bouchon
	97	0PJ004/ 0PJ200	Skive	Scheibe	Washer	Disque
	98	0PJ004/ 0PJ200	Skrue	Schraube	Screw	Vis

PT25-C G3

Pos.	No.	DANSK.	DEUTSCH.	ENGLISH.	FRANÇAIS.
99	0PJ004/ 0PJ200	Fjeder	Feder	Spring	Raccord
100	0PJ004/ 0PJ200	Fjederstop	Federstop	Springbase	Arrêt pour raccord
101	0PJ004/ 0PJ200	Kugle	Kugel	Ball	Bille
102	0PJ004	Udløserarm	Ablassarm	Release arm	Bras de déclenchem.
103	0PJ004/ 0PJ200	Rørstift	Rohrstift	Tube sprig	Goujon
106	0PJ004/ 0PJ200	Skive	Scheibe	Washer	Disque
107	0PJ004/ 0PJ200	Skruer	Schraube	Screw	Vis
109	0PJ004/ 0PJ200	Skruer	Schraube	Screw	Vis
111	0PJ222	Bøsning	Buchse	Bushing	Machon
112	0PJ222	Låsering	Seegerring	Lock ring	Circlips
113	0PJ004/ 0PJ200	Låseblok	Verriegelungsplatte	Locking ring	Plat de fermeture
114	0PJ004/ 0PJ200	Indsats	Einsatz	Insertion	Douille
115	0PJ004/ 0PJ200	Fjeder	Feder	Spring	Raccord
116	0PJ004/ 0PJ200	Stålmanchet	Manchette Stahl	Sleeve steel	Bague
117	0PJ004/ 0PJ200	U-manchet	Manchette, U	Sleeve, U	Baque
118	0PJ004/ 0PJ200	O-ring	O-ring	O-ring	Joint torique
119	0PJ004/ 0PJ200	Nylonskive	Nylonscheibe	Nylondisc	Rondelle nylon
120	0PJ004/ 0PJ200	Skrabering	Abstreifring	Scraper ring	Segment raqueur
121	0PJ004/ 0PJ200	Pakdåse	Stopfbuchse	Stuffing box	Ecrou de piston
122	0PJ004/ 0PJ200	Skrabering	Abstreifring	Scraper ring	Segment raqueur
123	0PJ004/ 0PJ200	O-ring	O-ring	O-ring	Joint torique
124	0PJ004/ 0PJ200	O-ring	O-ring	O-ring	Joint torique
125	0PJ004/ 0PJ200	Låsering	Seegerring	Lock ring	Circlips
126	0PJ004/ 0PJ200	Styr for stempel	Buchse für kolben	Steering, piston	Douille de piston
127	0PJ004/ 0PJ200	Nylonskive	Nylonscheibe	Nylondisc	Rondelle nylon
128	0PJ004/ 0PJ200	U-manchet	Manchette, U	Sleeve, U	Baque
129	0PJ004	Skive	Scheibe	Washer	Disque
130	0PJ004	Kugle	Kugel	Ball	Bille
131	0PJ004/ 0PJ200	Nylonskive	Nylonscheibe	Nylondisc	Rondelle nylon
132	0PJ004/ 0PJ200	O-ring	O-ring	O-ring	Joint torique
133	0PJ004/ 0PJ200	Kugle	Kugel	Ball	Bille
	**	Løsdele salg	Ersatzteilverkauf	Spare parts sale	Vente de pieces de rechange
	0PJ002	Håndtag, komplet	Handgriff, komplett	Handle, complete	Poignée, complète
	0PJ004	Hydraulikenhed, komplet	Hydraulikeinheit, komplett	Hydraulic unit, complete	Unite hydraulique, complète
	0PJ200	Reperations sæt	Reparaturatz	Repair kit	Jeu de réparation
	0PJ220	Løfteåg, komplet	Hubstange, komplett	Lifting lever, complete	Levier de levage, complète
	0PJ222	Styrehjul, komplet	Lenkrad, komplett	Steering wheel, complete	Roue de direction, complète
	0PJ223	Parallelogram, komplet	Parallelogramm, komplett	Parallelogram, complete	Parallelogramme, complète
	0PJ224	Tvillinghjul, komplet	Doppelräder, komplett	Dual wheels, complete	Roues duelles, complète
	0PJ225	Trækstang, komplet	Zugstange, komplett	Pull Rod, complete	Barre de traction, complète